

Cable Plug for coil E22 is 2 x 180°  
and for coil E30 is  
4 x 90° repositionable.  
Coil 360° rotatable.

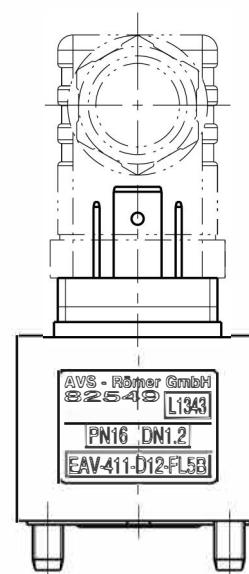
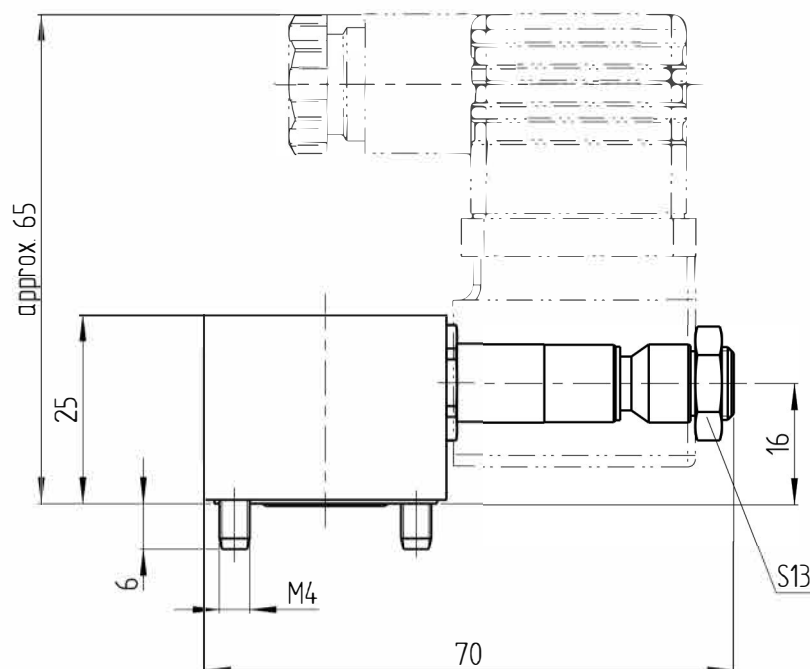

# **SPECIFICATION**

## **General**

Construction	Valve seat, elastic seal
Description	3/2-way flanged, solenoid valve
Operation	Electrical, direct acting
Model type	EAV-411-D12-FL5B-00
Function	"D", normally open, "3" closed
Nominal diameter	DN 1.2
Connection	Flange as per works standard
Ambient temperature	-20 °C up to +60 °C
Medium temperature	-10 °C up to +90 °C
Material	Valve body: Brass Ms Other internal parts: Stainless steel, non-ferrous metal and fiber-reinforced plastic material
Weight: - kg	Seal material: NBR
Fixation	Via 2 through holes in the valve body
Mounting position	Any, preferable vertical

## **Pneumatic - Hydraulic**

Nominal pressure	PN 16
Pressure range	0 up to 16 bar
Q <sub>Nn</sub> -value air	50 l/min
Mediums	Neutral gases
Response time	Opening time: approx. 7 - 20 ms; Closing time: approx. 12 - 20 ms

## **Electric**

Possible voltages	AC/DC
-------------------	-------

2017	Date	Name
Drawn	31.08.	C.Holler
Checked	31.08.	A.Mück

Scale	Edmac Item Number
1:1	300461855

